

A-A

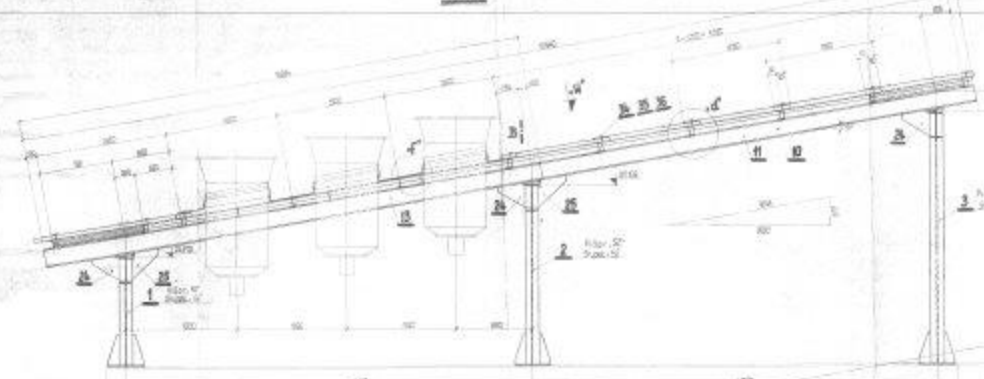

B-B

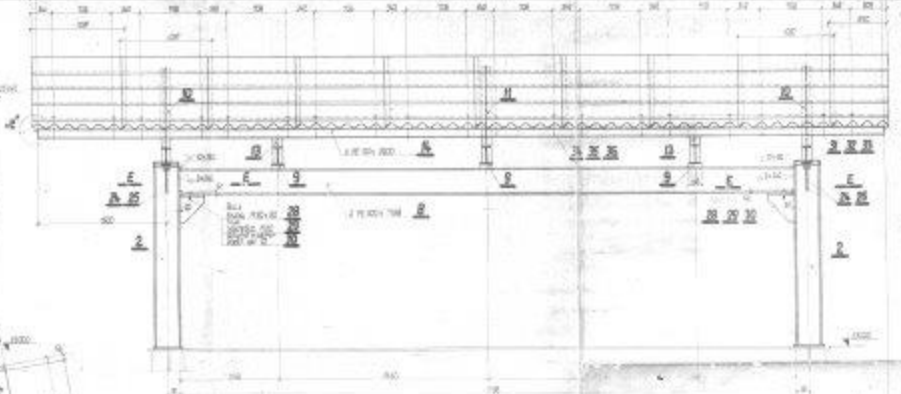

View  
Uzdok u'

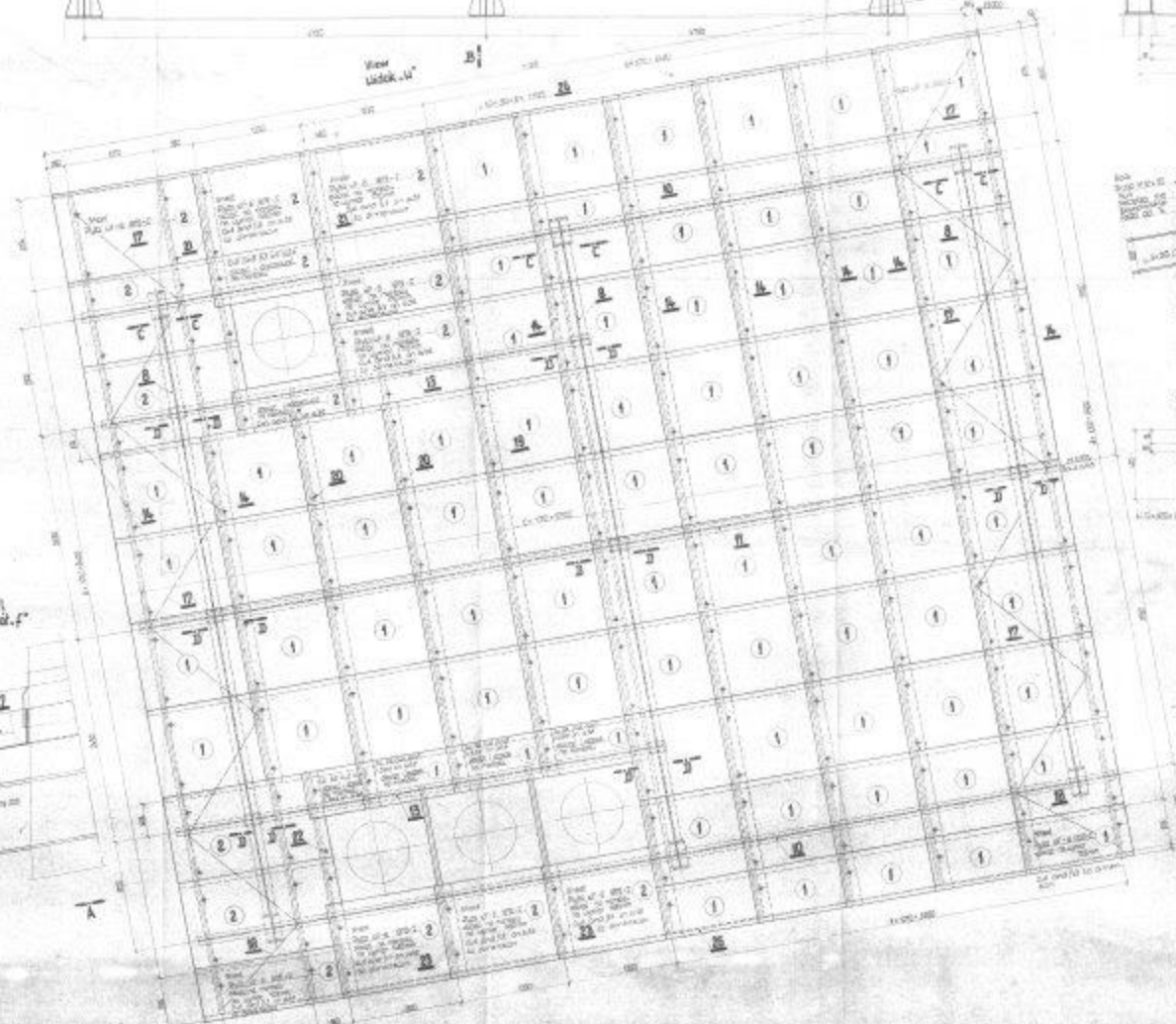

Detail  
Sreznok f'



C-C



Detail  
Sreznok d'



Detail  
Sreznok d'

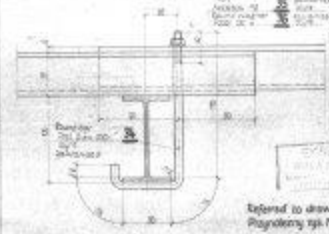

Pillars  
Stupak S<sub>1</sub>; S<sub>2</sub>; S<sub>3</sub>  
Luk je jak na rse. V wood timber  
required space as drawn, faces in mirror position  
condition.

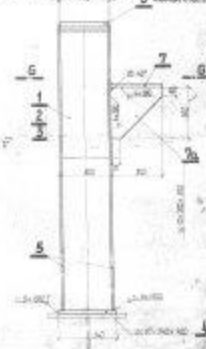

Detail  
Sreznok e'



Notes:  
1) Show up 4 of existing ground J...  
should be divided out and filled in with  
clay. Use 10-15% more cement in  
through out. See drawing for position  
of all structural members.

Design:

- 1) 2x100x100 - standard timber  
2) 1) 2) 100x100x100 - standard timber  
3) 100x100x100 - standard timber

Roofing - sheet 1

Refer to drawing  
Plyozhnyy sp. N 1-2-3-4

Significance of abbreviation:  
M - steel plate  
S - steel pipe for general engineering

Project name	Zadovnie kotta, pr. 1
Scale	1:500
Sheet number	6-207413