

Fixing of wearing plates at double walls
Befestigung der Schleißbleche an Doppelwänden

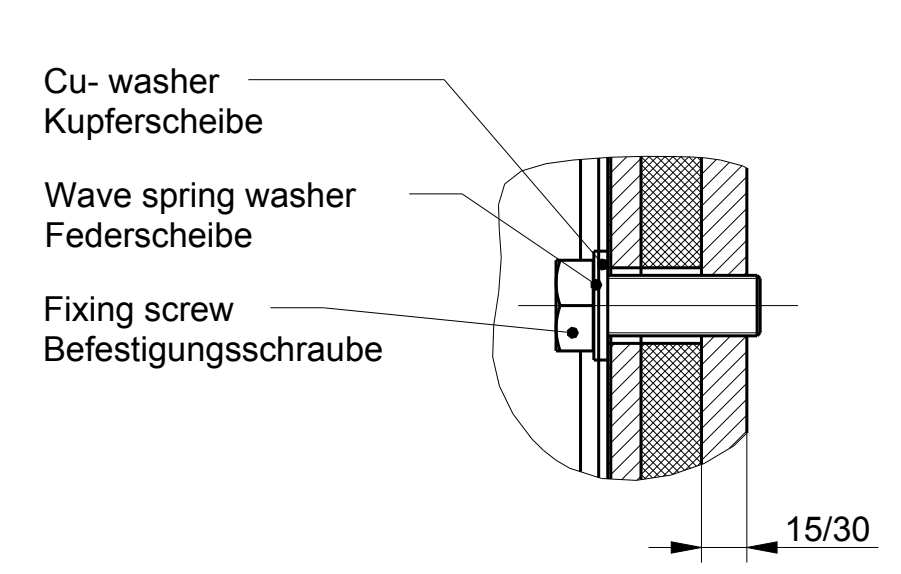

B(S)/P - Code:
X/X
Baugruppe - Assembly
Stückliste - Part list
Pos.-Nr. - Item-No.

Right hand construction as drawn
Left hand construction mirror inverted

Non marked parts are equal for right and left turning mills
Marked parts (R/L) are shown for right turning mills, parts for left turning mills are mirror inverted

AA	06.08.2018	Text added, different parts for right left turning mills marked from 154 for added	Cech	Liss	Tselos
00	07.11.2017	First issue	Cech	Liss	Tselos
REV NO.	DATE	DESCRIPTION	DESIGNED	CHECKED	APPROV
PROJECTOWNER					
PTOLEMAIS UNIT V 660 MW POWER PLANT CONTRACT DMKT - 11 09 5052			PUBLIC POWER CORPORATION S.A.		
CONTRACTOR			SUBCONTRACTOR DWG. NO.		
TERNA S.A. 85 MESOGEION AVE., 115 26 ATHENS, GREECE Tel.: +30 210 69 68 000, Fax: +30 210 69 68 099 e-mail: terna@terna.gr			MITSUBISHI HITACHI POWER SYSTEMS EUROPE N-100170-M-D16-ID16-00001-AA		
TITLE					
DGS 180 Wearing parts for inlet housing, sheet 1 Schleißteile zum Einlaufgehäuse, Blatt 1					
BG Ass.	SCALE		DRAWING NO.		SHEET
160	1:20		4311-M-D16-ID16-00001		01 of 01
Format	A0		REV. NO.		AA
THIS DRAWING SHALL NOT BE REPRODUCED, TRANSFERRED NOR REVISED WITHOUT OUR PRIOR WRITTEN APPROVAL. IT SHALL NOT BE MADE AVAILABLE TO THIRD PARTIES ANY AND ALL RIGHTS IN ACCORDANCE WITH THE GERMAN LAW ON COPYRIGHT (URRG) AND GERMAN ACT AGAINST UNFAIR PRACTICES (UWG) SHALL REMAIN UNAFFECTED.					

